

Parc Beibio, Morawelon

Proposed Layout

Project Description

The main priority for this group of young people (Morlo-on-Wheels) is to bring skateboarding facilities into their local community park. They have also been thinking about other teenage facilities, their location, security and access issues.

They have attended training days, approached equipment manufacturers and community designers, and raised money for consultation and a feasibility report. These are the results of all that hard work.

SKATEBOARDING

This is a local park not a town-wide facility, so quite modest resources are realistically being considered. Eg. Half/Quarter-pipe, Ramps, Fun-box, Grinding Rails, as illustrated.

The consensus amongst local residents and skateboarders is that they are best located upon the existing concrete hard-standing (with appropriate repairs or remedial treatment).

BIKE TRACK

Another popular suggestion has been for a pedal-cycle "bmx" type dirt track and this is proposed in conjunction with the skateboard park using the grassy humps and equipment described above.

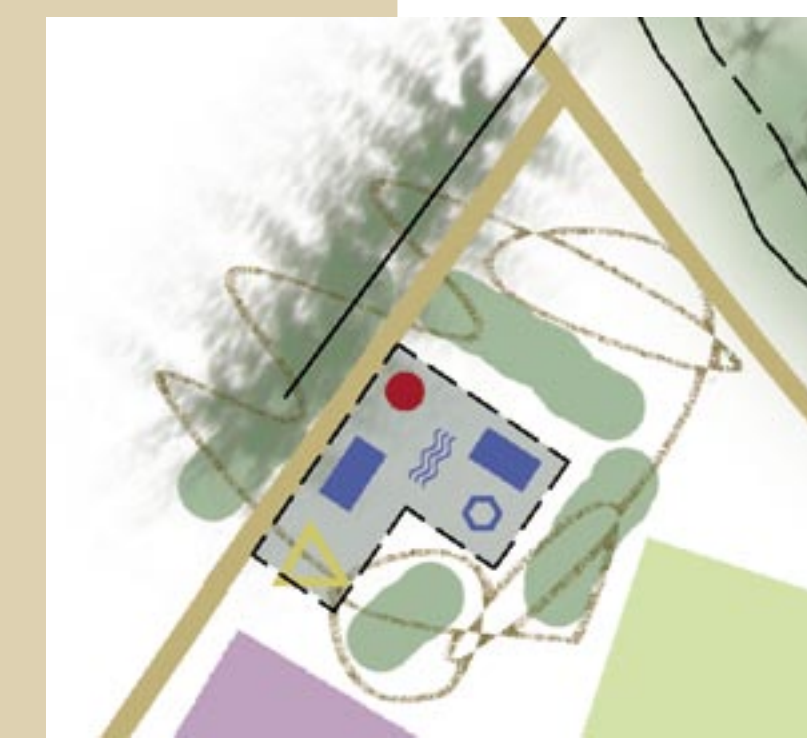

Skatepark, Teenzone Shelter & Dirt Track proposed for the concrete hard-standing and humps linked with new paths

TEEN-ZONE SHELTER

In conjunction with the above facilities teenagers are looking for places to simply meet friends. Non-skating and non-biking teenagers are also seeking equipment suited to their needs.

So an open teenage shelter (similar to the type at Gwelfor Community Centre) and teen-zone equipment is proposed close to skate/bike track. (see pictures)

ROUTES & ACCESS

An improved Parc Beibio with new play facilities deserves improved routes conveniently and safely linking with the adjoining community.

New paths along Cil Beibio front and the foreshore need to be linked together and take in the new and existing play resources along the way, without compromising future provisions.

ENVIRONMENT

Drainage, tree/shrubs, dog-free areas, benches for adults, etc.



KEY	
	Housing
	private grounds/gardens
	pitches
	existing play areas
	foreshore
	concrete hard-standing
	network of paths
	Skateboard equipment
	Teenzone shelter

These drawings are not design proposals, they are indicative sketches prepared to assist the consultative process and aid discussion. If you have any comments or queries please contact us or your local community development worker directly. These images are not to scale and are based on drawings reproduced from Ordnance Survey mapping with the permission of the Controller of Her Majesty's Stationery Office © Crown Copyright. Unauthorised reproduction infringes Crown Copyright and may lead to prosecution or civil proceedings.

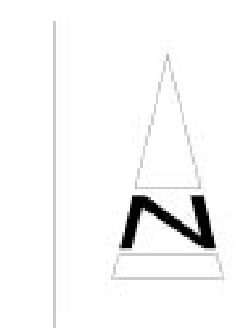

MorLo-on-Wheels

